

Remote Weld Bench

RWB-2000 and RWB-3000



Model RWB-2000

- Heavy-duty, 7-gauge work surface.
- Hinged side-wing panels for longer than normal workpieces.
- Ideal for multiple workers on larger model.
- Productivity increases and morale improves by providing a cleaner working environment.
- Ergonomically designed for operator comfort.
- Helps to meet OSHA Clean Air Standards.

Torit Remote Weld Bench

Equipment Options

- Fluorescent light fixture
- Easy Duct™ to ease installation
- Integration to other Torit Air Filtration Systems

Specifications

Model	Nominal cfm	Dimensions (in)					Outlet Diameter in	Shipping Weight lbs	Work Surface Max Load per sq ft lbs
		A	B	C	D	E			
RWB-2000	2000	52.0	52.0	38.7	42.1	75.0	8, 10, 12	511	150
RWB-3000	3000	52.0	78.0	38.7	42.1	75.0	10, 12	682	150

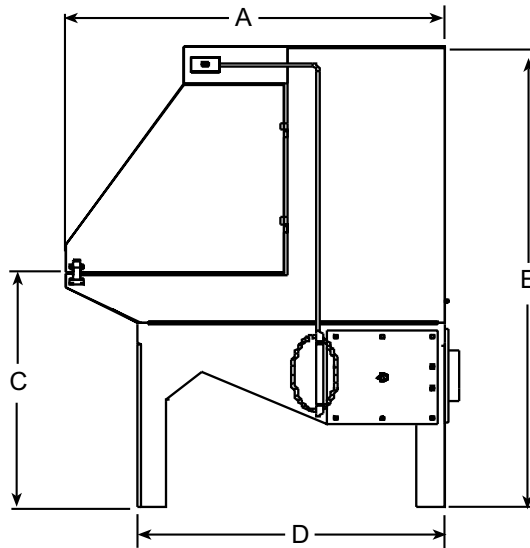
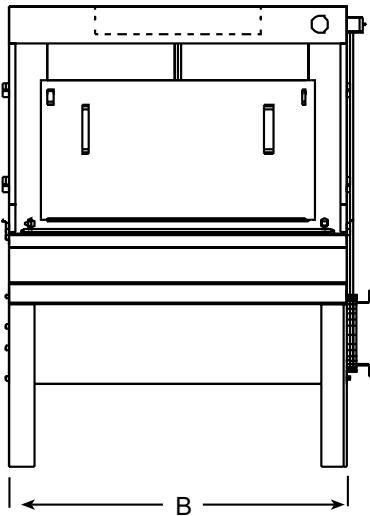

Information contained in this document is subject to change without notice.



Donaldson Company, Inc.
 Dust Collection Group
 P.O. Box 1299
 Minneapolis, MN 55440
 800-365-1331
 www.torit.com
 e-mail: dustmktg@mail.donaldson.com



© 2001 Donaldson Co., Inc.
 Printed in U.S.A.
 Printed on Recycled Paper

Form RWB (03/01)